

MODEL L-50 DIAGRAM W/ SOUNDBAR MOUNT + HINGED TOP GUIDES - PRIMARY CABINET DIMENSIONS

SPECIFICATIONS (CENTIMETERS ARE REPRESENTED BY [])

MAX TV SIZE : 65"
 MAX WEIGHT CAPACITY : 100 LBS [45.4 KG]
 MAX TRAVEL (EXTENSION) : 39.25" [99.7]
 LIFT SYSTEM HEIGHT : 29" [73.7] TO 41" [104.1]
 MAX TV + SOUNDBAR HEIGHT : 38" [96.5] MINUS LID THICKNESS

QUICK REFERENCE DIMENSION GUIDE (USE WHICHEVER IS GREATER)

TV DIMENSIONS : W____, H____, D____
 SOUNDBAR DIMENSIONS : SW____, SH____, SD____
 MIN. INTERIOR CABINET WIDTH : $W+2" [5.1] = \text{ } \text{OR } SW+2" [5.1] = \text{ } \text{OR } 34" [86.4]$
 MIN. LID CUTOUT WIDTH : _____
 MIN. INTERIOR CABINET HEIGHT : $H+SH+2" [5.1] = \text{ } \text{OR } 29.5" [74.9]$
 MIN. INTERIOR CABINET DEPTH : $D+8" [20.3] = \text{ } \text{OR } SD+7.5" [19.1] = \text{ } \text{OR } 34" [86.4]$
 MIN. LID CUTOUT DEPTH : _____

MIN. LID CUTOUT WIDTH = TV WIDTH + 2" [5.1] OR SOUNDBAR WIDTH + 2" [5.1] OR 34" [86.4] WHICHEVER IS GREATER

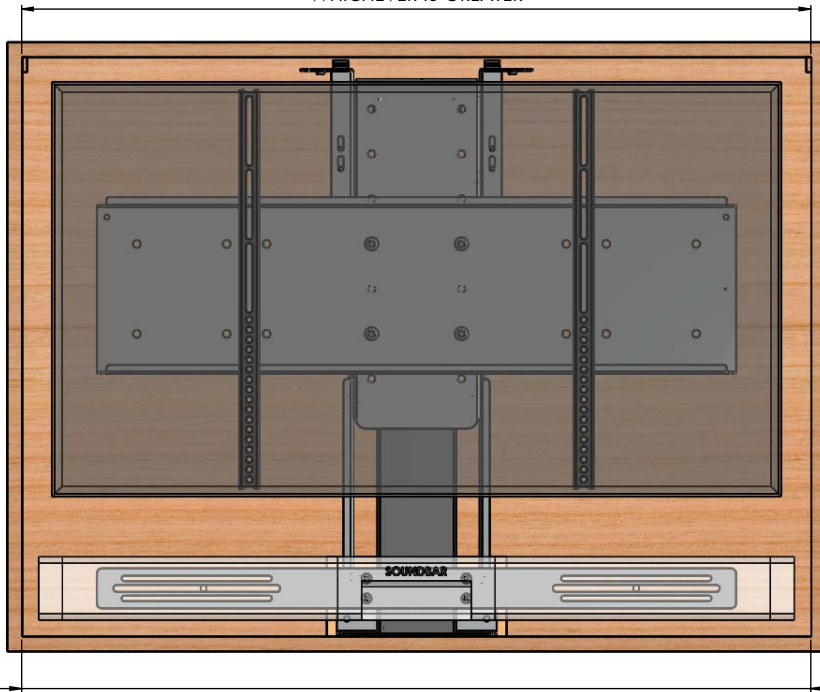

MIN. INTERIOR CABINET WIDTH = TV WIDTH + 2" [5.1] OR SOUNDBAR WIDTH + 2" [5.1] OR 34" [86.4] WHICHEVER IS GREATER

MIN. LID CUTOUT DEPTH = TV DEPTH + 8" [20.3] OR SOUNDBAR DEPTH + 7.5" [19.1], WHICHEVER IS GREATER

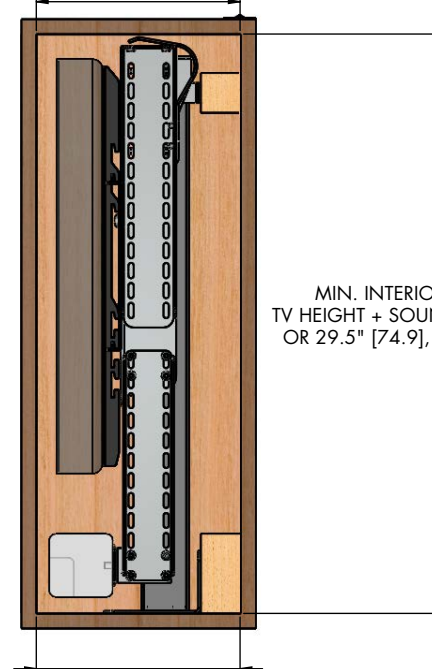

MIN. INTERIOR CABINET DEPTH = TV DEPTH + 8" [20.3] OR SOUNDBAR DEPTH + 7.5" [19.1], WHICHEVER IS GREATER

MIN. INTERIOR CABINET HEIGHT = TV HEIGHT + SOUNDBAR HEIGHT + 2" [5.1], OR 29.5" [74.9], WHICHEVER IS GREATER

NOTES:

1. THE CABINET BOX SHOWN IN THE DIAGRAM IS FOR REFERENCE ONLY AND IS NOT PROVIDED WITH THE LIFT SYSTEM
2. WHEN DETERMINING TV HEIGHT, ALWAYS USE MANUFACTURER SUPPLIED "TV WITHOUT STAND" HEIGHT
3. LIFT MECHANISM IS POWDERCOATED BLACK STEEL, COLORS IN DIAGRAM ARE FOR CLARITY ONLY

IMPORTANT HINGED LID INFORMATION

1. HINGED LIDS REQUIRE THE USE OF THE "HINGED TOP GUIDE" ACCESSORY
2. HINGES FOR THE LID ARE NOT PROVIDED BY NEXUS 21
3. SEE PAGE 2 OF THIS DRAWING FOR MORE DETAILED INFORMATION ABOUT THE HINGED LID

NEXUS 21

COPYRIGHT 2019 - ALL RIGHTS RESERVED
UPDATED 11/20/19

MODEL L-50 DIAGRAM

W/ SOUNDBAR MOUNT + HINGED TOP GUIDES - CABINET REFERENCE DIMENSIONS

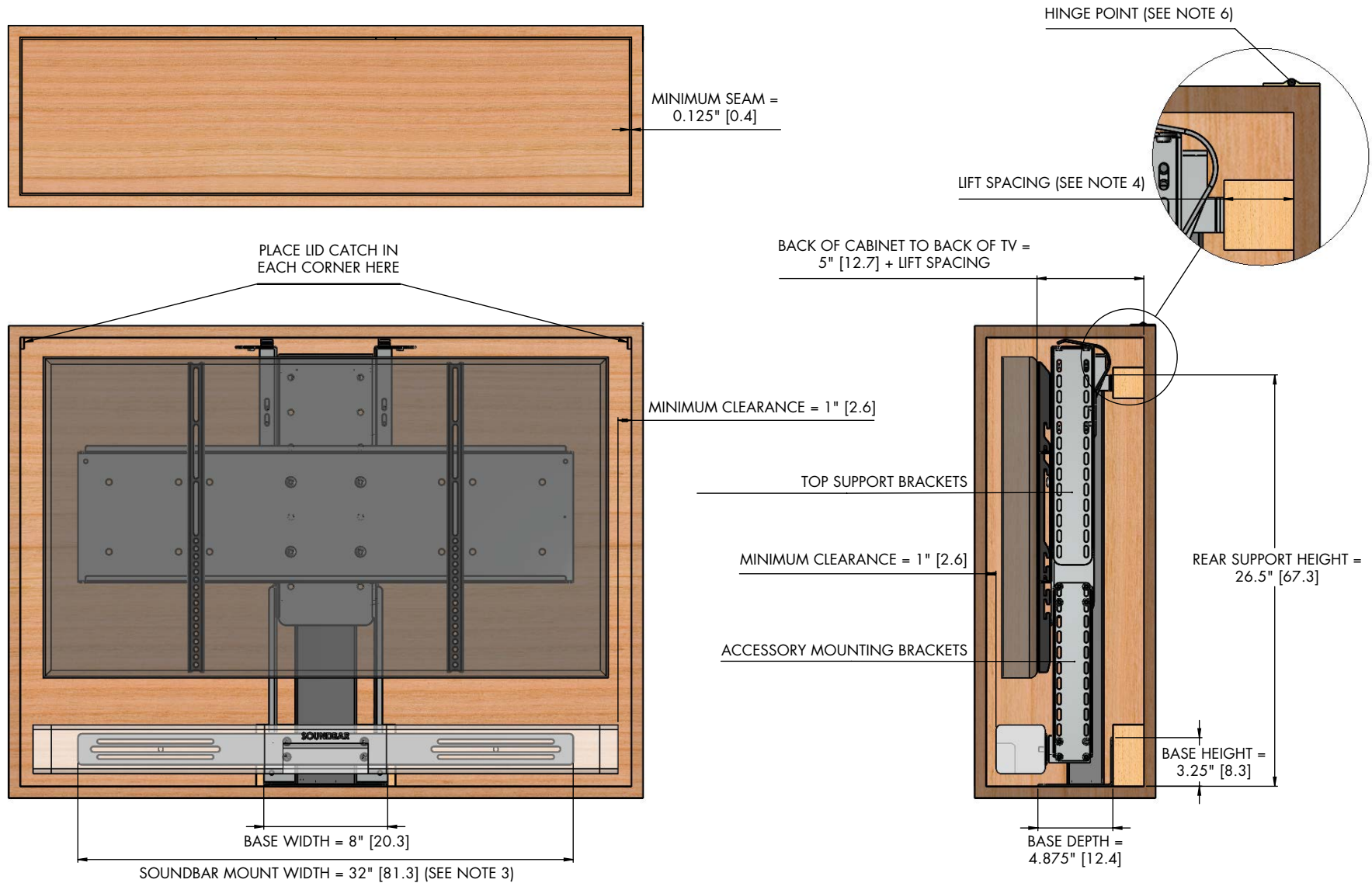

NOTES:

1. TOP SUPPORT BRACKETS ALLOW TOP PLATE TO BE ADJUSTED FLUSH WITH UNDERSIDE OF LID
2. ACCESSORY MOUNTING BRACKETS ALLOW SOUNDBAR TO BE ADJUSTED CLOSE TO UNDERSIDE OF TV
3. SOUNDBAR MOUNT FITS SOUNDBARS WITH MOUNTING LOCATIONS BETWEEN 14" [35.6] AND 30" [76.2] APART
4. THE LIFT SYSTEM MUST BE SPACED A MINIMUM OF 2" [5.1] AWAY FROM THE HINGE POINT REGARDLESS OF CABINET DEPTH
5. MINIMUM SEAM CAN BE REDUCED TO 0.0625" [0.2] WITH A 45 DEGREE BEVEL ON THE LID
6. PIANO HINGE SHOWN FOR REFERENCE; HOWEVER, OTHER HINGE TYPES CAN BE USED

NEXUS₂₁

COPYRIGHT 2019 - ALL RIGHTS RESERVED
UPDATED 11/20/19